

MICRO SPEAKER (ROUND TYPE)

Shape

KSM-50008-P



Model Number	KSM-50008-P
Rated Input (W)	0.2
Maximum Input (W)	0.5
Impedance (Ω)	$8 \pm 15\%$ @1KHz1.0V
Rated Frequency (Hz)	$580 \pm 20\%$ @1.0V
Sound Pressure Level (dB)	95 ± 3 dB(0.2W/10cm), 82 ± 3 dB(1W/1m)@1.0K, 1.4K, 1.7K, 2.0KHz
Frequency Range (Hz)	Fo---9K
Magnet (mm)	$\phi 12.5 \times 1.5$ Cobalt
Operating Temperature ($^{\circ}$ C)	-20 ~ +55
Weight (Gram)	13.6
Material	Metal

Dimension

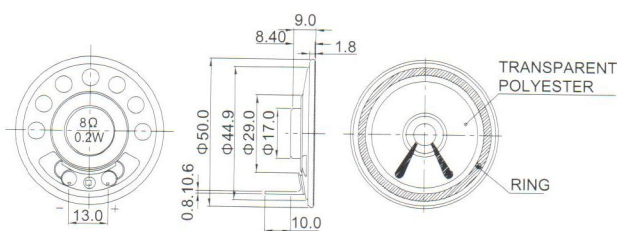

Tol : ± 0.5 Unit : mm

Characteristic

