

Требования к окружающей среде

Температура окружающей среды -55 °С - + 100 °С

относительная влажность воздуха + 40 °С, 93%

1 кПа атмосферное давление

Вибрация: 10-2000ZH, 150м / S2

ускорение: 490m / s2

Постоянное ускорение вибрации "" 245m / s2

Сопротивление изоляции: ≥5000mΩ

Номинальное напряжение: 400В

Выдерживаемое напряжение: 1000В

Время жизни: 500

IP67



FQ

Внешние размеры  
прямой пружиными

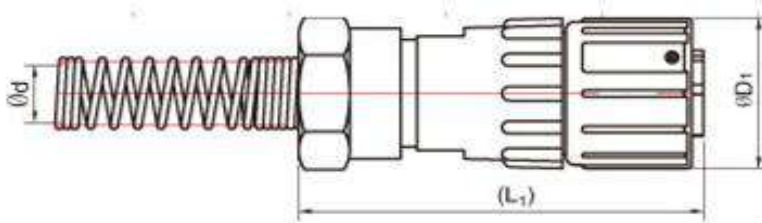

	ØD <sub>1</sub>	L <sub>1</sub>	Ød
FQ14	Ø21	47/50	Ø5/Ø6, 07/08
FQ18	Ø27	53	Ø6, 08, 09, 010
FQ24	Ø33	61	Ø6, 010, 012, 014
FQ30	Ø39	68	Ø14, 016, 018

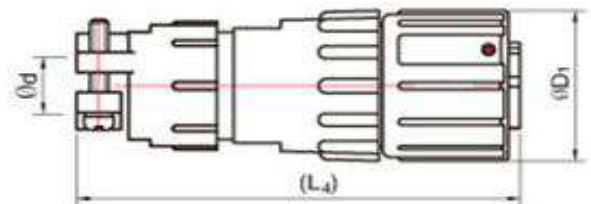

	ØD <sub>1</sub>	L <sub>4</sub>	Ød
FQ14	Ø21	56	Ø6, 07, 08
FQ18	Ø27	59	Ø6, 08, 09, 010
FQ24	Ø33	66	Ø6, 010, 012, 014
FQ30	Ø39	74	Ø14, 016, 018

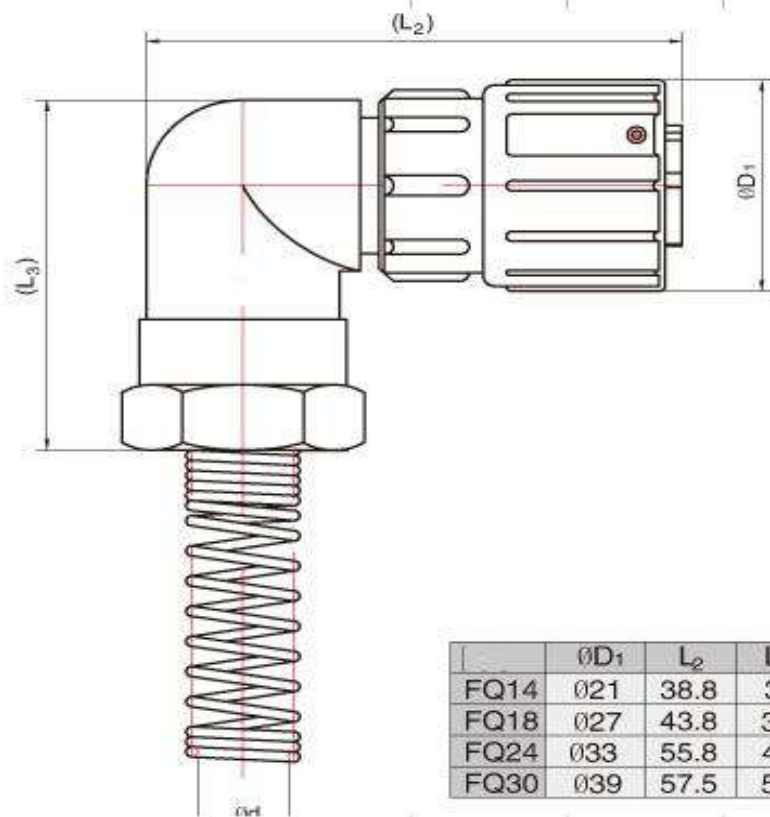

	ØD <sub>1</sub>	L <sub>2</sub>	L <sub>3</sub>	Ød
FQ14	Ø21	38.8	37	Ø6, 07, 08
FQ18	Ø27	43.8	38	Ø6, 08, 09, 010
FQ24	Ø33	55.8	45	Ø6, 010, 012, 014
FQ30	Ø39	57.5	50	Ø14, 016, 018

### Square Flange Receptacle

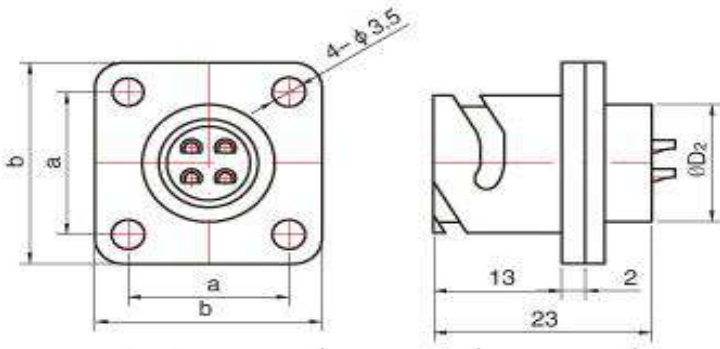

### Mounting Dimensions

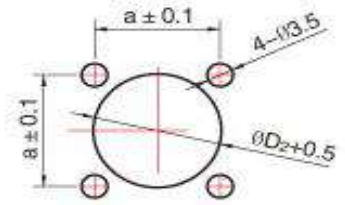

### Circular Receptacle:

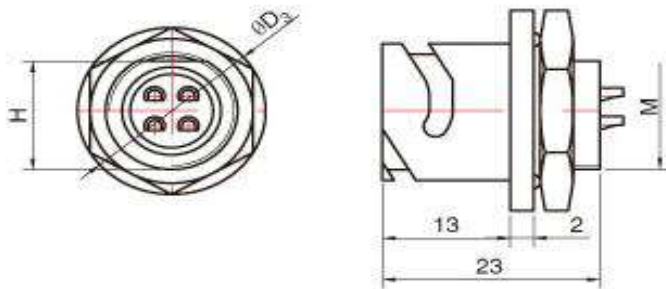

### Mounting Dimensions:

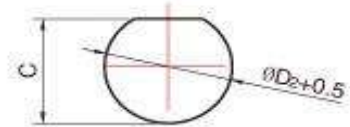

	ØD <sub>3</sub>	M	ØD <sub>2</sub>	H	C
FQ14	Ø19.7	M14 × 1	Ø14	13	13.2
FQ18	Ø23.8	M18 × 1	Ø18	17	17.2
FQ24	Ø30	M24 × 1	Ø24	23	23.2
FQ30	Ø36	M30 × 1	Ø30	29	29.2

### Spring Cable Receptacle

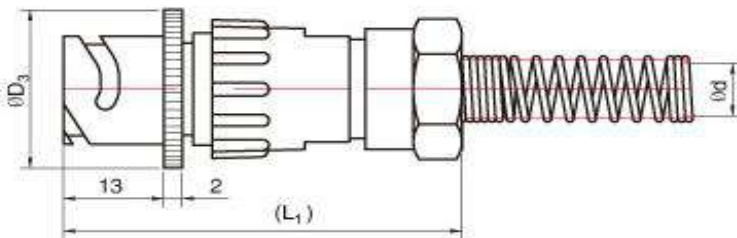

### : Waterproof Cable Receptacle

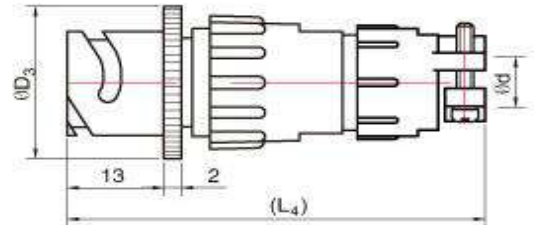

	ØD <sub>3</sub>	L <sub>1</sub>	Ød
FQ14	Ø19.7	47/50	Ø5/Ø6、Ø7/Ø8
FQ18	Ø23.8	53	Ø6、Ø8、Ø9、Ø10
FQ24	Ø30	61	Ø6、Ø10、Ø12、Ø14
FQ30	Ø36	68	Ø14、Ø16、Ø18

类型	ØD <sub>3</sub>	L <sub>4</sub>	Ød
FQ14	Ø19.7	56	Ø6、Ø7/Ø8
FQ18	Ø23.8	59	Ø6、Ø8、Ø9、Ø10
FQ24	Ø30	67	Ø6、Ø10、Ø12、Ø14
FQ30	Ø36	74	Ø14、Ø16、Ø18

Plastic Dustproof cover

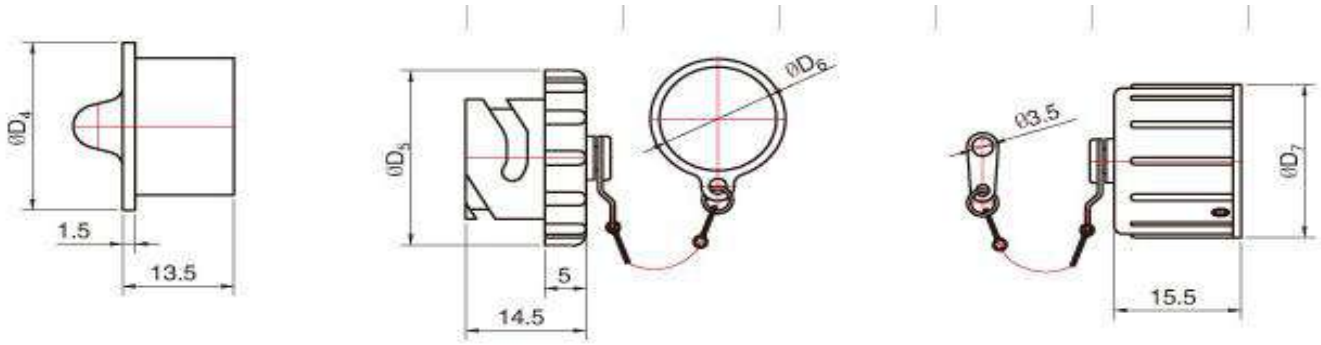

	$\varnothing D_4$	$\varnothing D_5$	$\varnothing D_6$	$\varnothing D_7$
FQ14	023	023	013.2/014.2/016.2	021
FQ18	028	028	016.2	026
FQ24	034	034	022.2	033
FQ30	040	040	026.2	039

 — 00.8

 — 01

 — 01.5

 — 02.5



FQ14-2



FQ14-3

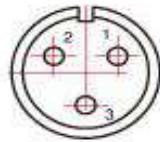

FQ14-3T

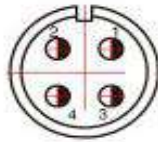

FQ14-4

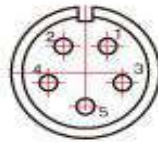

FQ14-5



FQ14-6



FQ14-7



FQ14-8



FQ14-9



FQ18-2

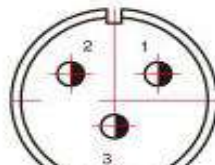

FQ18-3



FQ18-4



FQ18-5



FQ18-6



FQ18-7



FQ18-12

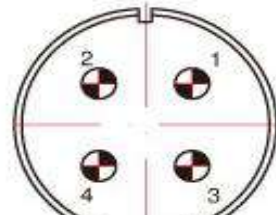

FQ24-4



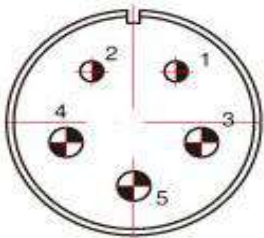

FQ24-5

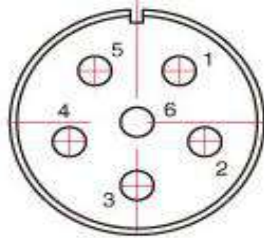

FQ24-6

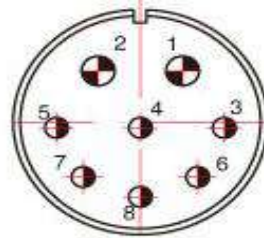

FQ24-8

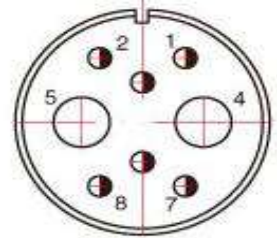

FQ24-8T

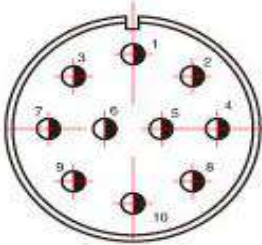

FQ24-10

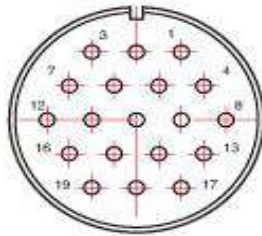

FQ24-19

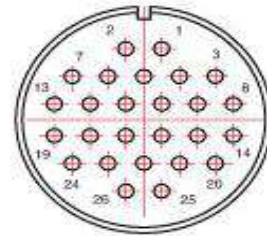

FQ24-26

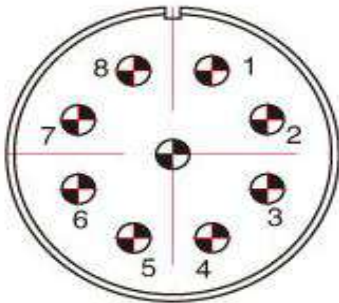

FQ30-9

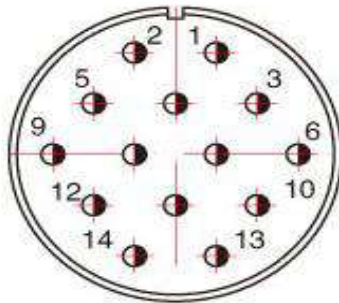

FQ30-14

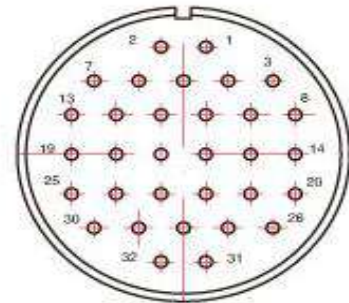

FQ30-32

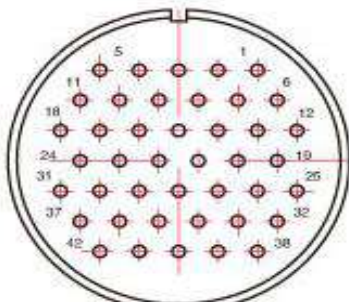

FQ30-42

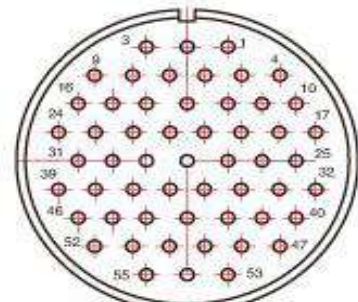

FQ30-55