

SECTION A-A

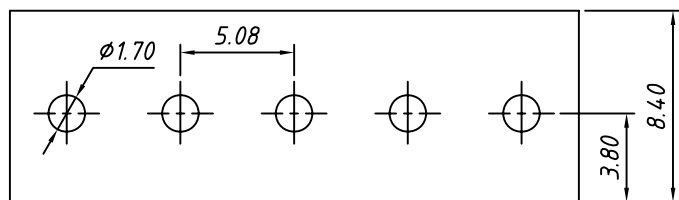

PCB LAYOUT

**Material**  
 Pin header: Brass, Tin plated  
 Housing: PA66, UL94V-0

**Electrical**  
 Rated voltage: 300V  
 Rated current: 15A  
 Contact Resistance: 20 mΩ  
 Insulation resistance: 500MΩ/DC500V  
 Withstand voltage: AC2000V / 1 min

**Mechanical**  
 Temp. Range: -40 °C ~ +105 °C  
 Soldering: 250°C 5Sec. Max.

*Order Information*

L-KLS2-EDV -5.08-XXP-4 XX

RoHS —  
 Terminal Block —  
 Pitch —  
 No.: of Pole —  
 Color: 4- Green —  
 Product Code: 00~99 —

GENERAL TOLERANCE		ANGLE TOLERANCE		PROJECTION	Description:	
.X	±0.60	.X	±5°	UNITS		Plug-in TERM BLOCK 5.08MM
.X	±0.38	.X	±3°	SHEET SIZE	A4	
.XX	±0.25	.XX	±2°	KLS P/N:	KLS2-EDV-5.08-XXP-4	

Draw by: Date	2015-09-01
Check by: Date	2015-09-15
SCALE	SHEET OF

KLS ELECTRONIC CO., LTD.